

REDUCING UNION

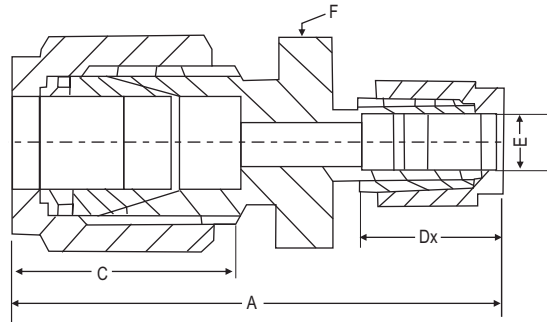

Dimensional Details :



Notes : Drawings are not to scale

Dimension, in.

Tube OD	Tube OD	Part Number	A	C	Dx	E	F
1/4	1/8	K4UR2	1.52	0.60	0.50	0.09	1/2
3/8	1/8	K6UR2	1.61	0.66	0.50	0.09	5/8
3/8	1/4	K6UR4	1.70	0.66	0.60	0.19	5/8
1/2	1/8	K8UR2	1.78	0.90	0.50	0.09	13/16
1/2	1/4	K8UR4	1.85	0.90	0.60	0.19	13/16
1/2	3/8	K8UR6	1.91	0.90	0.66	0.28	13/16
3/4	1/4	K12UR4	1.94	0.96	0.60	0.19	1 1/16
3/4	3/8	K12UR6	2.00	0.96	0.66	0.28	1 1/16
3/4	1/2	K12UR8	2.11	0.96	0.90	0.41	1 1/16
1	1/2	K16UR8	2.38	1.23	0.90	0.41	1 3/8
1	3/4	K16UR12	2.38	1.23	0.96	0.62	1 3/8

Dimension, mm.

Tube OD	Tube OD	Part Number	A	C	Dx	E	F
8	6	KM8URM6	42.3	16.2	15.3	4.8	14
10	6	KM10URM6	44.5	17.2	15.3	4.8	17
10	8	KM10URM8	45.1	17.2	16.2	6.4	17
12	6	KM12URM6	47.0	22.8	15.3	4.8	22
12	8	KM12URM8	47.8	22.8	16.2	6.4	22
12	10	KM12URM10	48.7	22.8	17.2	7.9	22
16	10	KM16URM10	45.9	24.4	17.2	7.9	24
16	12	KM16URM12	52.0	24.4	22.8	9.5	24
18	12	KM18URM12	53.5	24.4	22.8	9.5	27
25	18	KM25URM18	61.0	31.3	24.4	15.1	35
25	20	KM25URM20	62.3	31.3	26.0	15.9	35

Note:

- A and C dimensions are typical finger-tight

Dimensions and specifications shown are approximate, may vary from time to time.

Ventil tube fittings are ordered by part numbers as listed in this catalogue and other sizes will be available on request.